

User manual



vanraam
Let's all cycle



Tavara Balance



Van Raam BV
Aaltenseweg 56
7051 CM Varsseveld
The Netherlands

Versie 14.10

Table of contents

Table of contents.....	2
Contact details manufacturer.....	2
Conformity.....	2
Introduction.....	3
Delivery.....	3
Intended usage.....	3
Safety measures.....	4
Delivery inspection.....	5
Adjustment of the bicycle.....	5
Accessories.....	8
Silent electric motorsystem.....	11
Before the first use.....	15
Technical details.....	18
Maintenance and adjustments to be done by owner.....	19
Repairs and maintenance to be done by dealer.....	20
Disposal.....	21
Handover/sale to a new owner.....	21
Guarantee.....	21
Frame number.....	22

Contact details manufacturer

Van Raam BV
Aaltenseweg 56
7051 CM Varsseveld
The Netherlands

Tel. : +31 (0)315 257370
E-mail : info@vanraam.com
Internet : www.vanraam.com

Conformity

Van Raam declares as manufacturer that the Tavara Balance bicycle has been produced in accordance with the 93/42/EEG guidelines.

Introduction

This user manual gives important and necessary information about the use of your bicycle. We ask you to go through the manual thoroughly before using the bicycle.



**READ
THOROUGHLY!**

Delivery

- bicycle with possible packaging
- user manual(s)
- possible charger(s), depending on options
- sparekey(s)

Intended usage

The bicycle is designed for normal use on level and solid ground. The usual bicycle caution should always be taken into consideration. At the same time all safety instructions as described in this manual should be complied with explicitly. Also the local traffic rules should always be complied with.

All other use, including damage or physical injuries due to this, are not the manufacturer's responsibility.

Safety measures

- Ensure the bicycle is in good condition each time before using it. Check before **each** ride that the brakes are in order. Check the lighting and make sure there is enough tyre pressure.
- Regularly check whether the wheels, the handlebar and the saddle are securely fastened and also whether all screw joints are tight.
- Only use the bicycle on a **solid and level surface**.
- Make sure that wide trousers or loose hanging clothing don't get caught in the chain, spokes or pedals.
- Do not use a pressure washer or a steam cleaner for the cleaning of the bicycle.
- In case that the bicycle is equipped with the Silent electric motor system, make sure that you get used to riding with electric support. Beware when you turn on the system and make sure you don't get startled by unexpected behaviour because you turned on the electric support.
- Make sure that no dangerous speed develops when driving downhill and entering tunnels. Brake on time and don't ride faster than 30 kilometres per hour.

Load

The maximum load should not be exceeded. See information in the index of technical details on page 18. By permitted load we mean the total load, including the load on the luggage rack.

Make sure that the permitted load on the luggage rack is not exceeded.

Damaged or worn out parts

The replacement and repair of parts (frame, forks, lighting, brakes, drive mechanism and the handlebar) should **always** be performed by a dealer. If not, the guarantee ceases to be valid and you will be personally responsible in the event of possible damage.



Specific safety parts should **always** be replaced by new parts!

Delivery inspection

Check the delivery immediately after receiving it. In case of damage or incomplete delivery we ask you to contact your dealer immediately.

Adjustment of the bicycle

Before using the bicycle, adjust it to the measurements of the cyclist. This is of great importance, especially the saddle and the handlebar.



If an optimal adjustment of the bicycle, as defined in the instructions, is not possible, you can contact your dealer for a fitting solution.

The brakes are correctly adjusted and should only be adjusted by the dealer during periodic maintenance.

Saddle height

When the cyclist is sitting on the bicycle and can put a foot on the pedal in the lowest position, the saddle height is correct. Adjust the saddle height in such a way that the leg is stretched but relaxed in that position.

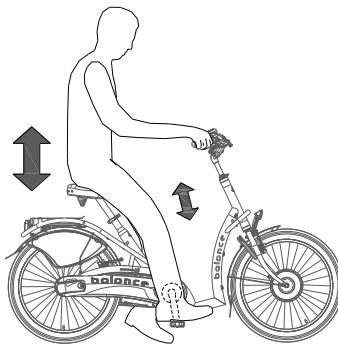

To adjust the saddle:

1. Open the quick-clamp [A].
2. Slide the saddle to the correct height.
3. Close the quick-clamp.



Make sure clothing cannot get caught in the clamp!



If the clamp closes too easily, the clamping force is too low. In this case, open the clamp and tighten the nut [B] a bit more. If a lot of force is necessary to close the clamp, the nut should be loosened slightly.

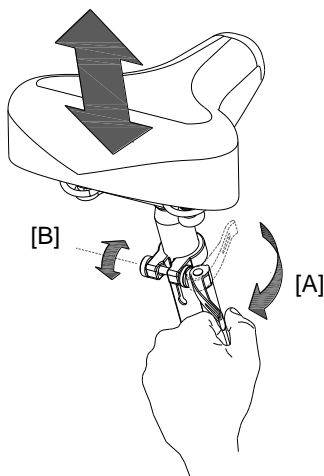

Do not pull out the saddle pin **further** than the marking. The tube will not go into the shank deep enough and will risk breaking off, which can lead to serious injuries.



Handlebar height

The height of the handlebar affects the comfort of the ride. It determines the pressure on the hands and the position of the back.

Determine your own most comfortable height by using the bike.

To adjust the handlebar:

1. Slightly loosen the screw by using an Allen key.
2. Slide the handlebar to the correct height and tighten the screw very firmly again.

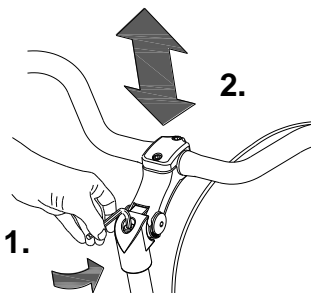

Do **not** pull out the handlebar **further** than the mark. Otherwise the tube will not be deep enough in the shaft and will risk breaking off, which can lead to serious injuries.



Position handlebar

You can tilt the handlebar. This influences the distance from the handlebar to the upper body. Determine your own most comfortable position by using the bike.

To tilt the handlebar:

1. Slightly loosen the screws (A) and (B) with an Allen key.
2. Put the handlebar in the desired position and then tighten the screws considerably.
3. Slightly loosen screw (C) with an Allen key, put the handlebar in the correct (horizontal) position and then tighten the screw again.

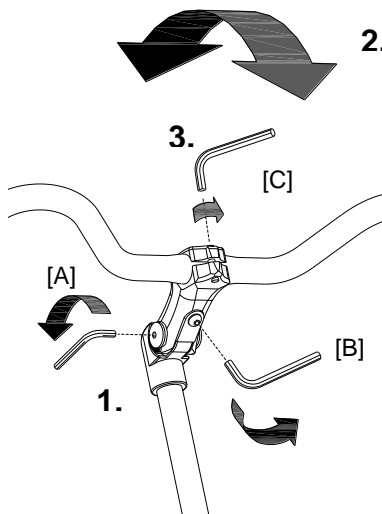

Depending on your order, you can use the accessories as described below.

Crank shortener

The crank shortener is fitted to the crank, as illustrated. The pedal can then be fitted into the crank shortener at two positions.

With the Allen screw (A) the crank shortener should be aligned with the crank.

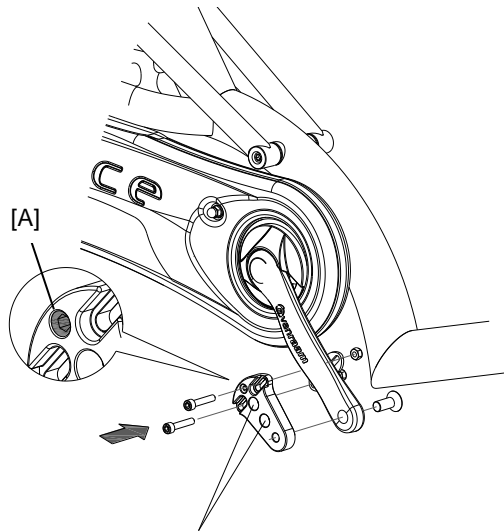

2 assembly points pedal

Eccentric crank

The bicycle can be fitted with an eccentric crank on the left and/or right side.

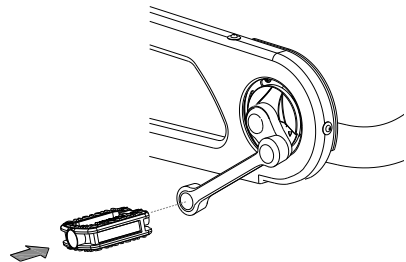

Flashing light system

To use the flashing lights press the switch [A] to the left or right.

If you want to switch off the flashing light system, put the switch in the middle position.

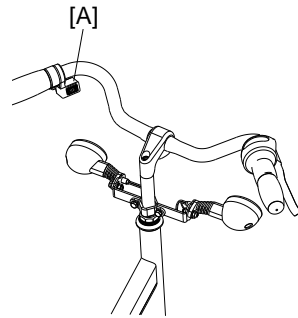

The lights work on a battery.

To replace the batteries, turn the screw on the cap and take the orange cap [B] away. Then remove the PCB [C] from the holder. You can now replace the battery [D].

This is a 3-volt lithium battery, CR123A.

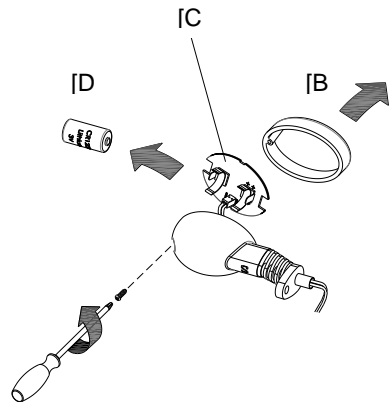

Foot support

In the foot support you can fix your foot by strapping on the Velcro [A]. The foot support is fitted to the pedal with a balance block.

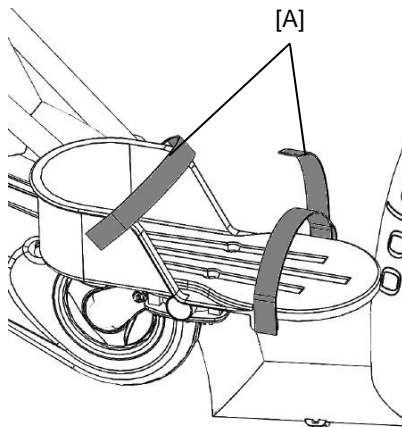

Walking-stick holder

You can take 2 walking-sticks with you in the stick holder. Place the walking-stick in the holder at the bottom side [A] and then secure the stick in the fastening device [B] at the top side.

Always fasten the walking-stick(s) with the Velcro band.

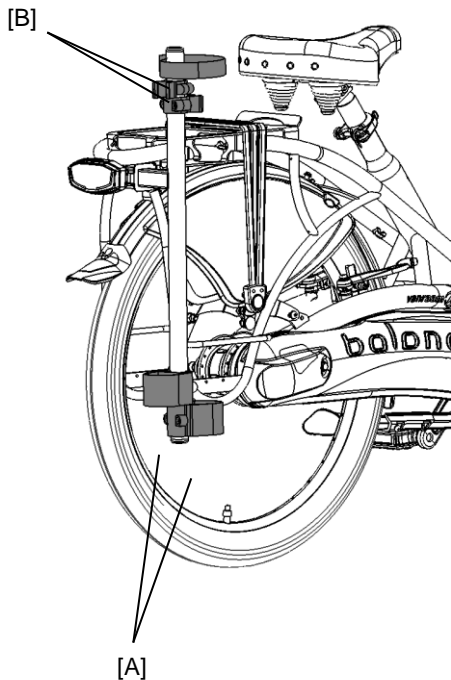

Silent electric motorsystem

The electric system has the following functions:

- Pedal assistance while cycling
- Start assist

Press the on/off button to turn on the system.

After the system is turned on, the electric motor is active in level 1.

Level 1 provides light support. Level 3 provides optimum support. You can change the degree of support while cycling.

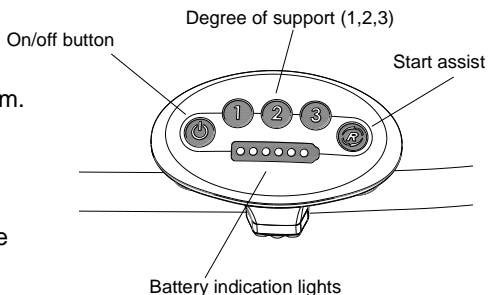

The Silent electric motor has a start assist. This allows the driver to accelerate without pedalling up to a speed of 5 km/h. To accelerate, press the start assist button and keep it pressed down. The motor is activated after a couple of seconds.

With the on/off button, you can turn off the system. When the system is not used, it will automatically turn off after a certain time.

You can see the battery level at the indication lights at the coloured display. If only the red light is on, the battery is almost empty and needs to be recharged or replaced by a new, fully charged battery.

When all lights flash, the battery is empty and the engine will not support you any longer while cycling.



When you don't use the electric system for a couple of days, the battery will go into sleep mode. This is to protect the battery. To get the battery out of sleep mode, you should cycle for a couple of metres while pressing the on/off button on the display. At the moment the display lightens up, the battery is out of sleep mode. When you cannot cycle at this moment, for whatever reason, it's also possible to connect the charger for a couple of seconds to get the battery out of sleep mode.



When you push the bicycle, turn off the system.

To charge the battery:

For the best performance and to prolong the life of the battery, we recommend that you charge the battery at home at room temperature.

1. Open the little lock by turning the key a quarter (to the right).
2. Pull the handle forward.
3. Take the battery pack from the holder.
4. Take the battery inside. Plug the charger into the plug contact of the battery.
5. Connect the charger plug into the socket. Turn the switch [A] 'on'. A green LED light on the charger will start to blink fast.



Beware! If the battery is not connected properly, the green LED light blinks fast.

6. Depending on the battery level, the charging time is about 1,5 hour. If the green LED light stays on, the battery is fully charged.
7. Once the battery is charged, pull the plug from the socket first or turn switch [A].
8. Then pull the connector from the battery.

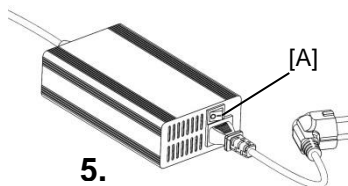
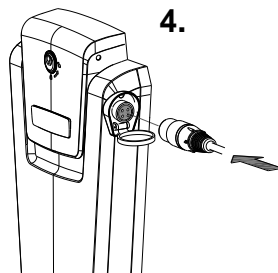
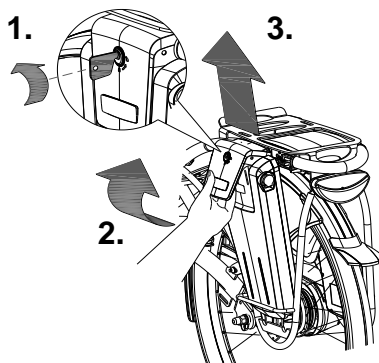

When charging the battery, **first** connect the charging point and **then** insert the plug into the socket!

After being charged, **first** disconnect the socket and only **then** remove the charger from the tricycle!



If a red LED light on the charger starts blinking, remove the plug from the socket and don't use the charger any more. Contact your dealer.

9. Put the battery back in the holder. Slide it behind bar [A] and press it firmly on strip [B].
10. Pull the handle backwards and push the battery on the top to the connector as shown in the drawing and close the lock.
11. Push the handle forward and close the lock.

It is also possible to charge the battery while it is still in the holder.

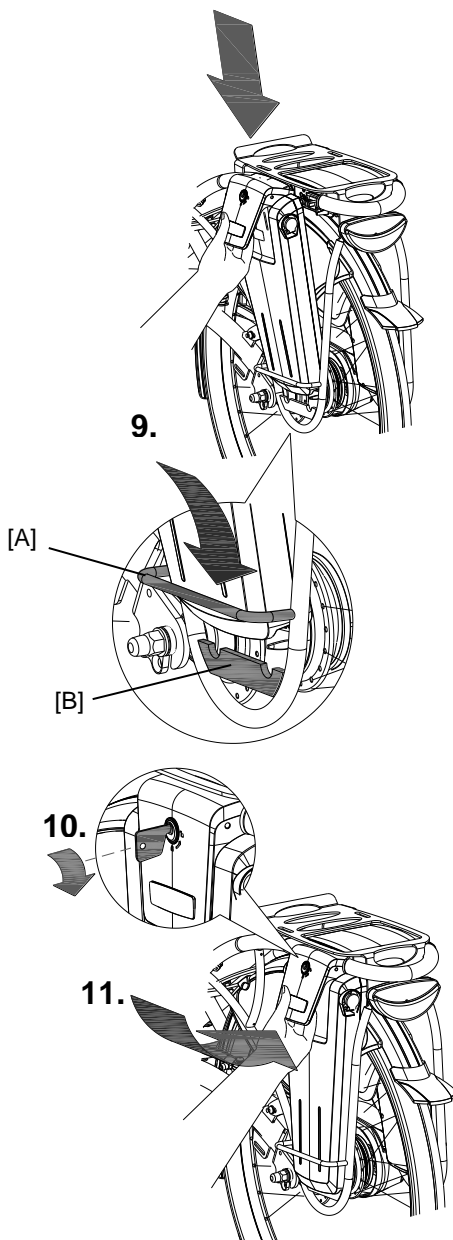

Ensure that the battery is always pushed straight into the holder.



Make sure that the switch is set to the side the battery is placed.

Backup battery (optional)

The bike can be supplied with a second battery.

To activate the second battery (when the first battery is empty) turn the switch under the luggage carrier to the right sight in order to activate the second battery.

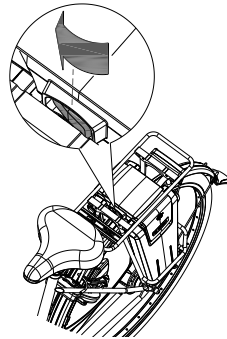

Keep in mind that your bike provides less support when it's cold (-10°C and less) and the battery will discharge faster. Charging also takes more time at lower temperatures.



The action radius depends on a lot of different factors and is strongly influenced by: capacity and voltage of the battery, degree of support that is used, temperature, wind speed, tyre pressure, cycling speed, weight of the user and the luggage, use of gearing etcetera.

Charging and maintenance tips for the battery



Every battery discharges automatically over time. This process is called self-discharge. A battery that is empty and not charged, will self-discharge and within two months will be deep discharged. The battery can be permanently damaged during this process. In case of deep discharge, the warranty will be voided.

Beware:

- Never stall the bike with an empty battery. We advise to charge the battery as soon as possible when it's totally empty.
- Only charge the battery with the supplied charger!
- Make sure that the battery is not charged at a temperature lower than 5°C. We advise to charge the battery at room temperature.
- Only use the charger in non-humid indoor environments, the charger may *not* get wet.
- Charge the battery until the green LED light on the charger continues to stay on.
- The battery housing and charger housing may never be opened! When there is a problem, contact your dealer.
- Don't charge the battery in full sunshine.
- Don't drop the battery, this can cause damage.

Gears

Standard the bicycle has 8 gears. The gears are used by turning the grip. **Do not use the pedals** when turning the grip.

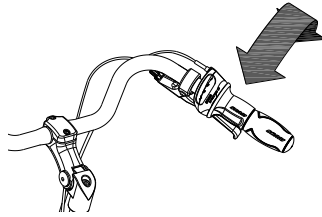

Lights

Headlight

The headlight has a switch (sliding switch) with 3 positions: **Off- Auto-On**. The headlight can be manually switched on or off with the “On/Off” position. In the “Auto” position, the headlight turns on or off automatically with the help of light & movement sensors. When the bicycle stands still for a while, the light will automatically turn off.

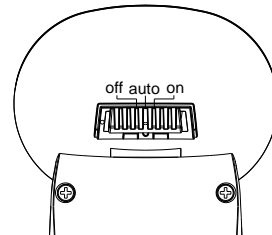
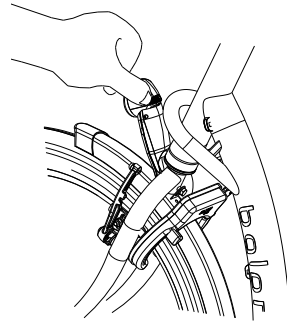

Adjusting the headlight

Set the angle of the headlight such that the centre of the light beam falls approximately 10 m ahead of the bike.

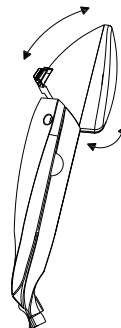

Replacing batteries

The headlight works on batteries. When the batteries are almost empty, a red LED light flashes on the headlight. Follow the next steps to replace the batteries.

1. Remove the 2 screws at the back of the front light.



In case you cannot easily reach the screws, slightly loosen screw [A] and tilt the light a quarter turn, so the screws are better accessible.

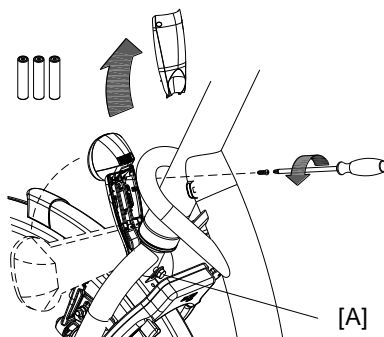
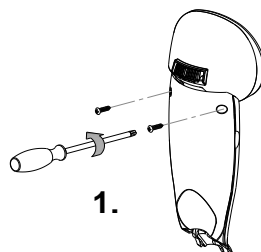
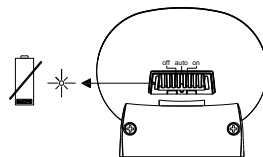

2. Dismantle the rear cover by pressing with the thumb and index finger at the cavity on both sides of the front cover and pulling the rear cover back.

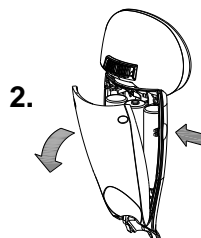

3. Replace the alkaline batteries (1.5 V - 1500 mA) and assemble the rear cover.

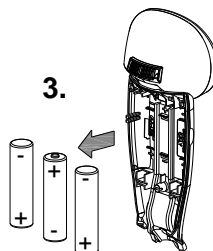

Rear light

The rear light has three options which you can choose by pressing the button repeatedly: **On-Auto- Off**.

The setting is as follows:

Press **1x**: light is on

Press **2x**: lighting is automatic

Press **3x**: light is off

With the “On” or “Off” mode, the rear light can be manually switched on and off.

With the “Automatic” mode the rear light automatically turns on and off with the help of light- and movement sensors. When the bicycle stands still for a while, the light will automatically turn off.

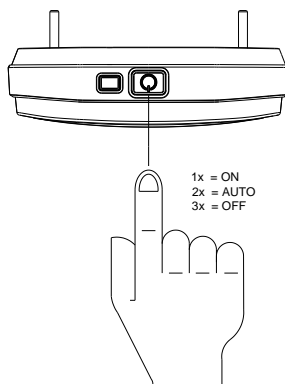

The rear light works on batteries. When the batteries are almost empty, a red LED light on the top starts flashing. To replace the batteries, follow the next steps:

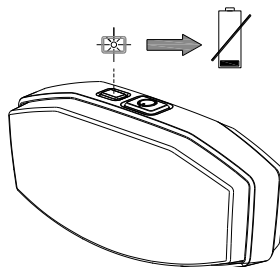

1. Dismantle the cover of the holder by pressing in the lip at the bottom of the light.

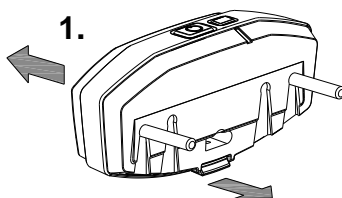

2. Replace the alkaline batteries (1,5 V - 1500 mA) and assemble the cover.

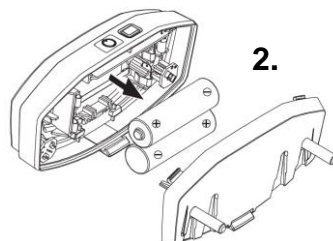

*Batteries cause environmental pollution.
Follow the local regulations
during disposal.*

Check before every ride:

- the brakes
- the tyre pressure
- the lights
- that all parts are fitted properly

Contact your dealer and do not use your bicycle if you identify any irregularities!

As with all mechanical parts, the bicycle is subject to wear and tear and high loading. If a component fails, it can lead to very dangerous situations. This can lead to damage or injuries to the user of the bicycle. Any form of tearing, scratching or changing of colour is an indication that the part should be replaced.

Important safety points for the cyclist

- Be very careful during the first ride.
- When riding the bicycle hold both hands firmly on the handlebar and feet on the pedals.
- Test the riding style of the bicycle on rough ground at moderate speed. This way the cyclist learns how to react to unexpected movements of the bicycle and the handlebar during use.
- Small obstacles should be cycled over with appropriate speed.
- Obstacles higher than 5 cm should be avoided.
- Ensure that no dangerous speed develops while driving downhill and entering tunnels. Brake on time.

Technical details

Length (cm)	182
Frame height (cm)	52
Boarding height (cm)	23
Front wheel	24"
Back wheel	24"
Weight (kg)	From 19
Max. load luggage rack (kg)	15
Total max. load (kg)	135
Brakes, front	Cantilever brakes
Brakes, back	Cantilever brakes

Maintenance and adjustments to be done by owner

Below you can find the instructions for maintenance and adjustments that you can do yourself on a regular basis, which will keep your bicycle in top condition.

Cleaning

The frame of the bicycle can be cleaned with a damp cloth. For areas that are dirtier you can use a mild detergent. The wheels can be cleaned with a damp brush with plastic hairs (not a wire brush!). The saddle and the grips can be cleaned with mild soap and water.



Do not use a pressure washer or a steam cleaner!

Inspection of the bicycle

After 200 kilometres or after a period of 2 months the bicycle should be inspected. Check the brakes, the lighting and the spokes. Also check the tyre tread depth. This should be at least 1 mm. Worn out tyres or possible faulty parts should be replaced.

The correct tension of the chain

The chain should not be too tight. It should hang loose. Without effort you should be able to move the chain up and down, half a centimetre approximately.

To keep the tension of the chain correct, a special tensioning wheel is fitted by the pedal axis.

To adjust the tensioning wheel:

1. Slightly loosen the screw. Hold the nut on the backside with a wrench, otherwise the screw can't be loosened.
2. Move the tensioning wheel such that the chain hangs loose as described above.
3. Tighten the screw firmly.

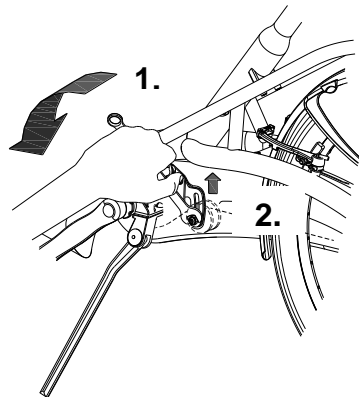

The right lubricant

The chain should be cleaned and maintained at regular intervals (every 3 months approximately). Only use special chain grease or Tevlon spray. This is the only way to make sure that the chain will run smoothly, will stay water resistant and will not rust. Wipe the chain with a cloth, treat it with grease or spray and remove any excess lubricant with a rag.

Other parts should not be treated with a lubricant.

Checking the rim

Due to the combined action of the brake and the rims, not only the brake lining but also the condition of the rim is important. For this reason the rim should be checked at regular intervals, for example when you inflate the tyres. The presence of fine cracks in the spoke punches or deformation of the rim when there is higher air pressure, indicate more serious wear and tear. In that case the rim should be replaced, because it can lead to loss of brake function or even a crack in the rim, which can lead to all kinds of dangerous consequences.

Repairs and maintenance to be done by dealer

It is recommended that the bicycle has a yearly inspection carried out by the dealer. In the event of technical trouble or faults, the bicycle should be taken to the dealer for repairs **immediately**.

The replacing of safety-related components (especially frame, brakes, lighting, handlebar, front fork and actuation) should be performed by the dealer.

If you still decide you want to replace components yourself, you are responsible for damage or harm due to incorrectly fitted components.

Only use **original** spare parts, which you can buy at you dealer. If requested the dealer will make the necessary information on repair and maintenance available.

Disposal

If you want to dispose your bicycle, contact your dealer. You can also contact the local waste disposal company. They will dispose the bicycle according to the regulations of your town.

Handover/sale to a new owner

When you hand over your bicycle to a new owner it is important that you also hand over all necessary technical documentation so that the new owner can use the bicycle safely.

Guarantee

The guarantee is valid for all faults in the product, which are proven to be caused by material or manufacturing error.

For our bicycles we give a guarantee of 5 years on the frame and the front fork. For the paint, all accessories and other parts (except wear parts) we provide a 2 year guarantee, as legally regulated.

Beware!

The guarantee as well as the product liability in general expires if the instructions stated in this manual are not followed. This is also the case if unauthorized maintenance is carried out or if technical changes or additions are made without permission of Van Raam.

Frame number

The frame number is printed on the sticker. This sticker is located on the frame, see the image below.

Example sticker:



Position of sticker:



on backside of the saddle tube

Date
Manufacturer	Van Raam
Type of bicycle	Tavara Balance
Frame number	
Key number	